

REINOL[®]

HAND CLEANER

DISPENSER KIT INSTRUCTIONS

TO INSTALL

Drill suitable holes in wall, using 10mm masonry drill bit
Mount dispenser using bolts and plugs provided

TO REFILL

Follow Instructions to refill (see diagram below)

NOTE:

REMOVE END CAPS AND PLASTIC SEALS FROM BOTH ENDS OF NEW CARTRIDGE BEFORE USE !



1. REMOVE EMPTY CARTRIDGE

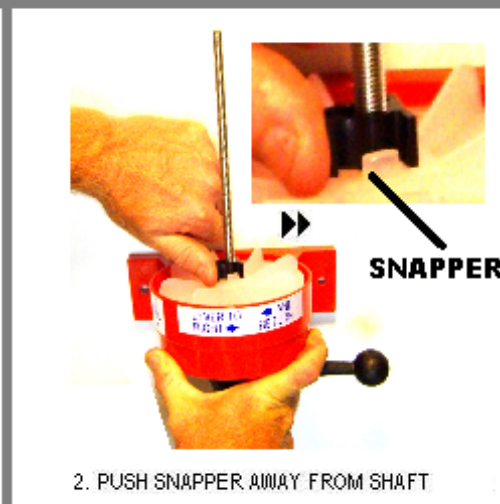

2. PUSH SNAPPER AWAY FROM SHAFT

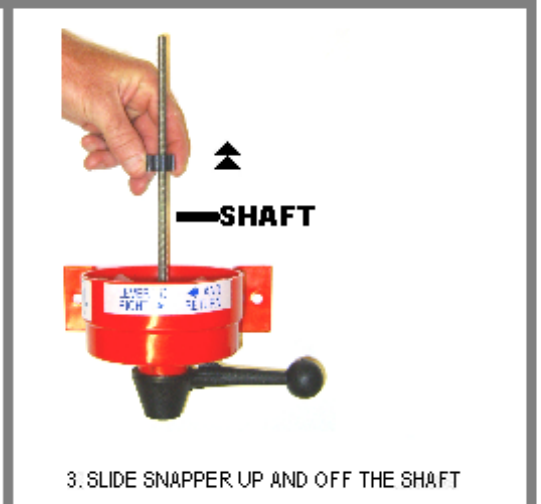

3. SLIDE SNAPPER UP AND OFF THE SHAFT

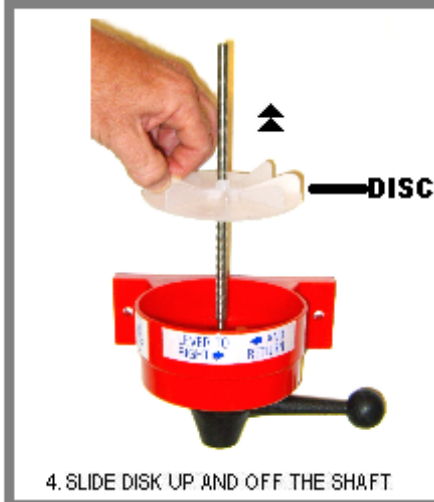

4. SLIDE DISK UP AND OFF THE SHAFT



5. SLIDE IN NEW CARTRIDGE



6. PLACE DISK ON TOP OF SOAP



7. SLIDE SNAPPER DOWN SHAFT



8. PLACE SNAPPER BETWEEN GUIDES

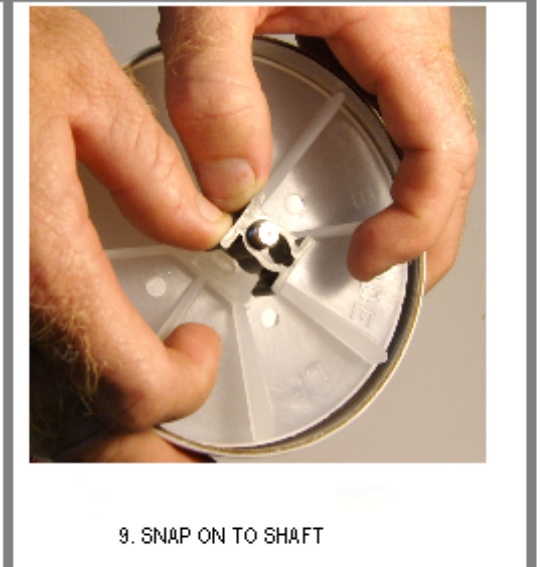

9. SNAP ON TO SHAFT

10. CRANK HANDLE UNTIL HANDCLEANER DISCHARGES FROM OUTLET LOCATED ON BASE